

PUBLIC PATH DIVERSION ORDER

TOWN AND COUNTRY PLANNING ACT 1990, SECTION 257

Hertfordshire County Council (Thorley 10 and Sawbridgeworth 1) Public Path Diversion Order 2016

This order is made by Hertfordshire County Council ('the authority') under section 257 of the Town and Country Planning Act 1990 because it is satisfied that it is necessary to divert the bridleway to which this Order relates in order to enable development to be carried out in accordance with planning permission granted under Part III of the Town and Country Planning Act 1990, namely the permission referenced 3/1304-13 granted by Hertfordshire County Council for the extraction and removal of materials to enable the construction of a 44 million gallon agricultural reservoir at Thorley Hall Farm, Thorley Wash, Bishop's Stortford.

BY THIS ORDER

1. The footpath and the bridleway over the land shown by the bold black line on the attached plan ('the Order Plan') and described in Part 1 of the Schedule to this Order ('the Schedule') shall be diverted as provided below.
2. There shall be created to the reasonable satisfaction of Hertfordshire County Council an alternative highway for the use as a replacement for the said footpath and bridleway as provided in Part 2 of the Schedule and shown by bold black dashes on the attached Order Plan.
3. The diversion of the footpath and bridleway shall have effect on the date on which Hertfordshire County Council certify that the terms of Article 2 have been complied with.
4. The following works shall be carried out in relation to the highway described in Part 2 of the Schedule: installation of waymark posts, vegetation clearance, and harrowing and rolling where necessary to provide a firm and level surface.
5. Where immediately before the date on which the footpath and bridleway are diverted there is apparatus under, in, on, over, along or across them belonging to statutory undertakers for the purpose of carrying on their undertaking, the undertakers shall continue to have the same rights in respect of the apparatus as they then had.

SCHEDULE

PART 1

Description of Site of Existing Path or Way

The full width of that part of Sawbridgeworth Footpath 1 commencing at the junction with Thorley Footpath 11 at TL 4840 1825 (point A on the Order Plan) and continuing in a

generally north westerly direction for approximately 55 metres to TL 4836 1828 (point B on the Order Plan).

The full width of that part of Thorley Bridleway 10 commencing at TL 4841 1828 (point C on the Order Plan) and continuing in a generally north westerly direction for approximately 490 metres to TL 4802 1858 (point D on the Order Plan).

PART 2
Description of Site of Alternative Highway

A public footpath commencing at the junction with Thorley Footpath 11 at TL 4840 1825 (point A on the Order Plan) and continuing in a generally northerly direction for approximately 35 metres to join Thorley Bridleway 10 at TL 4841 1828 (point C on the Order Plan).

Width: 4 metres

A public bridleway commencing at the junction with Thorley Bridleway 10 at TL 4841 1828 (point C on the Order Plan) and continuing in a generally northerly direction for approximately 70 metres, passing to the west of the pond at TL 4841 1834 (point E on the Order Plan), to the track at TL 4841 1835 (point F on the Order Plan). Then continuing in a generally northerly direction for approximately 140 metres on the west side of Thorley Wood to TL 4839 4848 (point G on the Order Plan), then in a generally north westerly direction for approximately 400 metres on the south side of Thorley Wood to TL 4804 1866 (point H on the Order Plan), then in a generally south westerly direction for approximately 95 metres on the west side of the field to rejoin Thorley Bridleway 10 at TL 4802 1858 (point D on the Order Plan).

Width: 4 metres

IN WITNESS whereof the COMMON SEAL of HERTFORDSHIRE COUNTY COUNCIL
was hereunto affixed this day of 2016

The Common Seal of
HERTFORDSHIRE
COUNTY COUNCIL
was hereunto affixed
in the presence of:-

Chief Legal Officer

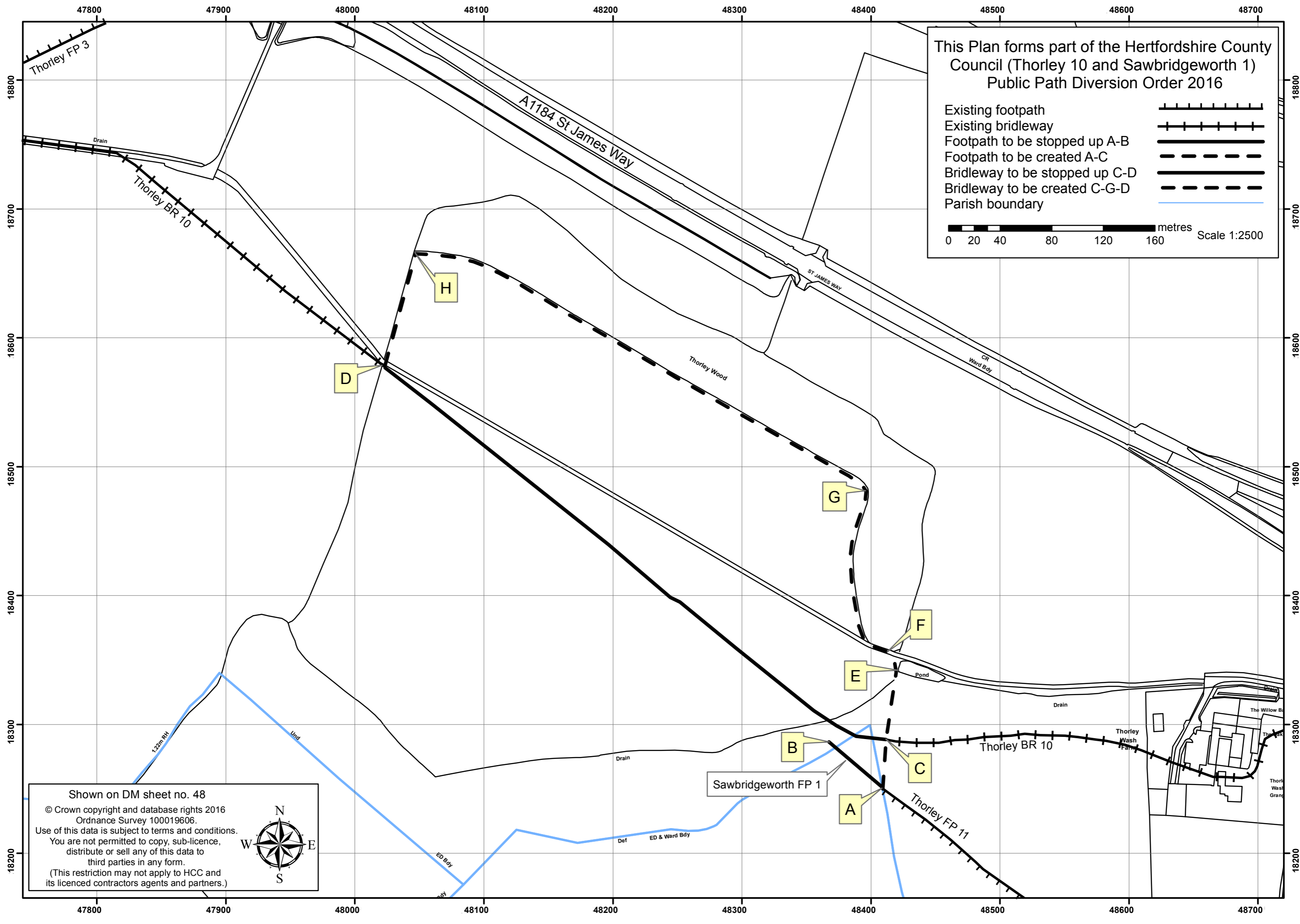

This Plan forms part of the Hertfordshire County Council (Thorley 10 and Sawbridgeworth 1) Public Path Diversion Order 2016

- Existing footpath
- Existing bridleway
- Footpath to be stopped up A-B
- Footpath to be created A-C
- Bridleway to be stopped up C-D
- Bridleway to be created C-G-D
- Parish boundary

0 20 40 80 120 160 metres Scale 1:2500

Shown on DM sheet no. 48

© Crown copyright and database rights 2016
Ordnance Survey 100019606.
Use of this data is subject to terms and conditions.
You are not permitted to copy, sub-licence, distribute or sell any of this data to third parties in any form.
(This restriction may not apply to HCC and its licenced contractors agents and partners.)

Sawbridgeworth FP 1

D

H

G

F

E

B

C

A

18200

18400

18600

18800

47800

47900

48000

48100

48200

48300

48400

48500

48600

48700